



North of Scotland
0800 300 999
Central Southern England
0800 072 7282

Your ref - Footpath from East Lane (D20502) to D20503

In any reply quote - MSS316634

Kerry Smyth
Technical Officer Assistant (Orders)
Regulation Team
Dorset Highways
Dorset County Council
County Hall, Colliton Park
Dorchester
Dorset, DT1 1XJ



Asset Data Team
P.O. Box 6206
Basingstoke
Hampshire
RG24 8BW

Your local Depot is: POOLE
P.O.Box 2004
Poole
Dorset
BH12 1YT
Tel. 01202-784600
Fax. 01202-784651

Dear Sir/Madam

24/08/2017

Coombe Cottages, Bradford Abbas, Sherborne DT9 6JN

In response to your enquiry of 24/08/2017 regarding the location of network and equipment at the above address, copies of our Record Plans are enclosed.

The plans show the positions and normal depths for the buried cables etc. when they were installed. It must be stressed, however, that alterations to road alignments, surface levels and buildings may have been made subsequent to the records being taken. If you find plant or cables that are not marked or are incorrectly marked, then you are required to contact us as soon as possible to give us the opportunity to amend our records.

Please note that the plans supplied are based on the location/map information supplied by yourselves and, therefore, YOU MUST SATISFY YOURSELF THAT OUR PLANS SUPPLIED ADEQUATELY COVER THE AREA THAT YOU REQUIRE.

Please note that these records only show plant owned by Scottish and Southern Electricity Networks. There may be other privately owned plant in the area, which is outside the control of Scottish and Southern Electricity Networks. You should check with the Local Authority, National Grid Co., Department of the Environment, other Regional Electricity companies etc. before proceeding.

Avoidance of DANGER from BURIED CABLES

For more information, consult the Health & Safety Executive's booklet HS(G) 47 - obtainable from the HSE. Guidance notes are contained in Scottish and Southern Electricity Networks' 'Watch-It' leaflet, which sets out various do's and don'ts when digging near buried cables.

I would particularly draw your attention to the need to take trial holes to determine the exact position and depth of cables to avoid the risk of injury to staff or damage to the cables.

Where our Record plans indicate the presence of cables with a voltage exceeding 11,000 volts then you are advised to contact our Local Depot section on the above telephone number before commencing any excavations within the vicinity of these cables.

Avoidance of DANGER from OVERHEAD LINES

For more information, consult the Health and Safety Guidance Note GS.6 obtainable from the HSE. Scottish and Southern Electricity Networks' 'Watch-It' leaflet outlines the precautions to be taken.

Inveralmond House, 200 Dunkeld Road, Perth PH1 3AQ www.ssen.co.uk

If in any doubt about the safety of working in the vicinity of overhead lines, please do not hesitate to contact our Local Depot at the above number.

Cable Records - Service Connections

The location of service cables to individual properties, street lighting, traffic signs, telephone kiosks etc. installed prior to the introduction of the Electricity Supply Regulations 1988 dated 1st October 1988 are not shown on the enclosed plans but details are available from our local depot POOLE Tel: 01202-784600.

General Advice

- a) Please ensure, where appropriate, that your CONTRACTORS have a copy of this letter and the enclosed plan(s).
- b) Please note that the cost of any repairs or claims against Scottish and Southern Electricity Networks as a result of your works will be invoiced to you or your contractor.
- c) Scottish and Southern Electricity Networks retains the right to its property, including disconnected cables and recoverable materials.

Special Advice

WAYLEAVES - We can only supply details of Wayleave agreements on receipt of written permission from the land owner or their solicitor.
Please re-submit your enquiry with an authorisation letter from the owner, to our Wayleave Registry Office, enclosing copies of high and low voltage records. They will then provide the appropriate wayleave information. There is a charge of 50 GBP plus VAT per search with a copy of the agreement. Please send your cheque, payable to SSE plc. to:
SSE, Wayleave Registry, Henderson Road, Inverness, IV1 1SW.
Tel. No. 01463 728081.

Should you require further information, please do not hesitate to contact me on the above telephone number.

Yours faithfully,

Asset Data Manager

Enclosures:

- Mains Record Plans HV	: Y	- Mains Record Plans LV	: Y
- Mains Record Plans GAS	: N	- Pipe Record Plans Water\Sewerage\Steam	: N
- 'Watch-It' for working near O/H lines	: Y	- 'Watch-It' for digging near U/G cables	: Y
- Other	:		

*
* THESE PLANS HAVE BEEN SENT IN RESPONSE TO YOUR RECENT ENQUIRY TO OUR ASSET DATA TEAM. *
*
* YOU COULD IN FUTURE ACCESS OUR PLANT INFORMATION VIA A SECURE WEB SITE. THIS IS A FREE *
* SERVICE WHICH IS AVAILABLE 24/7, THIS WOULD ALLOW YOU TO VIEW & PRINT OUR PLANT RECORDS *
* AS REQUIRED. *
*
* ACCESS TO THIS SERVICE CAN BE ARRANGED BY CONTACTING THE ASSET DATA TEAM BY EMAIL OR PHONE: *
*
* Asset.Data@sse.com 01256 337294 *
*
* INFORMATION REQ: CONTACT NAME, COMPANY NAME, TELEPHONE NUMBER & EMAIL ADDRESS. *
*

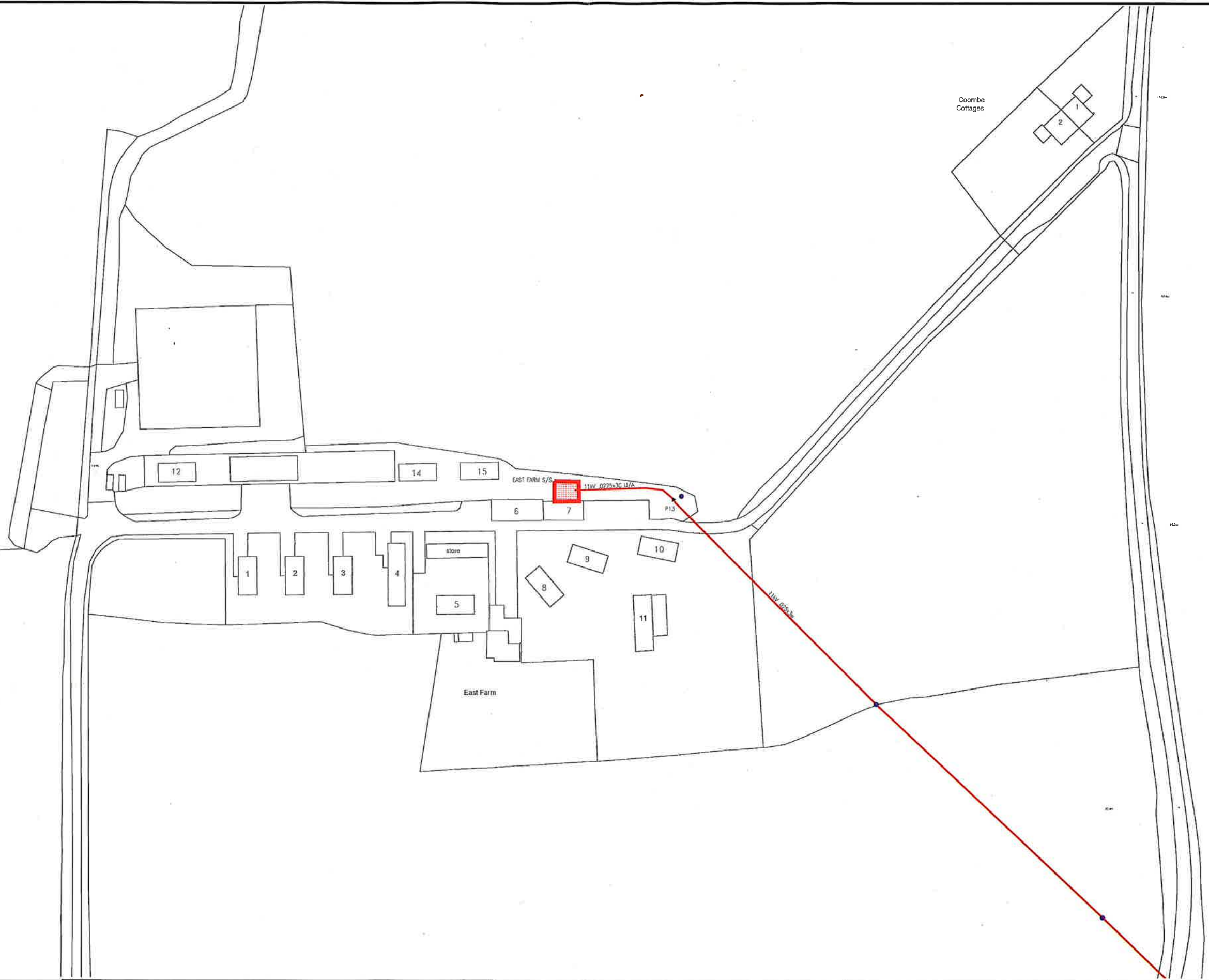

NORMAL DEPTH TO THE TOP OF THE CABLE WHEN LAID

	services	l.v.	h.v.	e.h.v.
FOOTPATH/UNMADE	0.45m	0.45m	0.60m	0.80m
ROAD CROSSING	0.60m	0.60m	0.75m	0.90m
AGRICULTURAL	1.00m	1.00m	1.00m	1.10m
l.v./services	- up to 1000V.			
h.v.	- over 1000V. to 11,000V.			
e.h.v.	- 22,000V. to 132,000V.			

WARNING

There may have been subsequent alterations to the surface levels. Trial holes must be taken to determine positions and depth of cables. HS (G) 47 Booklet from the Health and Safety Executive - Avoiding Danger from Buried Cables - should be consulted before commencing excavation work. (available from the HSE)

WHEN WORKING IN THE VICINITY OF OVERHEAD LINES THE HEALTH AND SAFETY GUIDANCE NOTE GS6 SHOULD BE CONSULTED. (AVAILABLE FROM THE HSE)

BASED UPON THE ORDNANCE SURVEY MAP WITH THE SANCTION OF THE CONTROLLER OF H.M. STATIONERY OFFICE. CROWN COPYRIGHT RESERVED.

This copy has been made by or with the authority of Southern Electric Power Distribution plc. pursuant to section 47 of the Copyright, Designs and Patents Act 1988 (the Act). Unless the Act provides a relevant exception to copyright, the copy must not be copied without the prior permission of the copyright owner.

Southern Electric Power Distribution plc.
Registered in England No. 04094290
Registered Office: 55 Yassem Road,
Reading, Berkshire, RG1 6NU

Coombe Cottages, Bradford Abbas, Sherborne DT99 6JN

UNCONTROLLED COPY

Subject to Revision Master held at



If you are unsure & need to seek advice before commencing excavations please contact

POOLE
01202-784600

H.V. MAINS RECORD

Grid Ref: ST58891548

Scale: 1:1250

Date: 24/08/2017

MSS316634